

LEGEND

	SITE BOUNDARY
	EXISTING PROPERTY BOUNDARY
	EXISTING EASEMENT BOUNDARY
	EXISTING SEWER
	EXISTING WATER
	EXISTING UNDERGROUND ELECTRICITY
	EXISTING OVERHEAD ELECTRICITY
	EXISTING GAS
	EXISTING NBN
	EXISTING TELECOMMUNICATIONS
	EXISTING COMMUNICATIONS
	ABANDONED SERVICE
	EXISTING BATTER
	EXISTING FENCE
	LIMIT OF WORKS
	PROPOSED STORMWATER DRAINAGE
	PROPOSED ROOFWATER DRAINAGE
	PROPOSED KERB AND CHANNEL IN ACCORDANCE WITH COUNCIL STD DRG BSD-2001
	PROPOSED CONCRETE INVERT IN ACCORDANCE WITH COUNCIL STD DRG BSD-2001
	DRAINAGE STRUCTURE LABEL
	EXISTING ROAD
	PROPOSED FOOTPATH IN ACCORDANCE WITH COUNCIL STD DRG BSD-5201
	PROPOSED ROAD PAVEMENT
	PROPOSED DRIVEWAY HARDSTAND
	PROPOSED DRIVEWAY CROSSOVER IN ACCORDANCE WITH COUNCIL STD DRG BSD-2021
	DIRECTION OF FALL
	BASEMENT OUTLINE BELOW

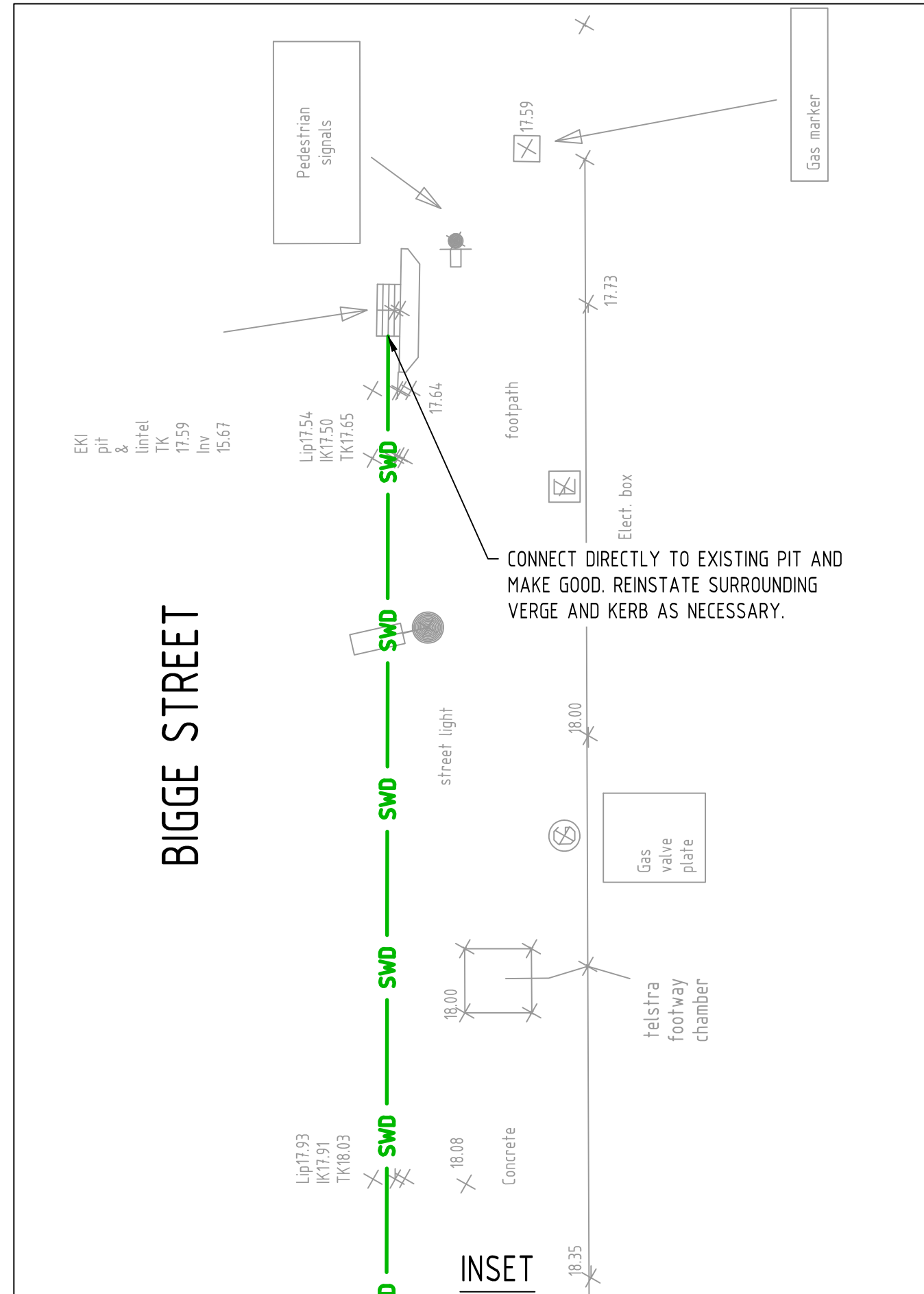

BIGGE STREET

REFER INSET

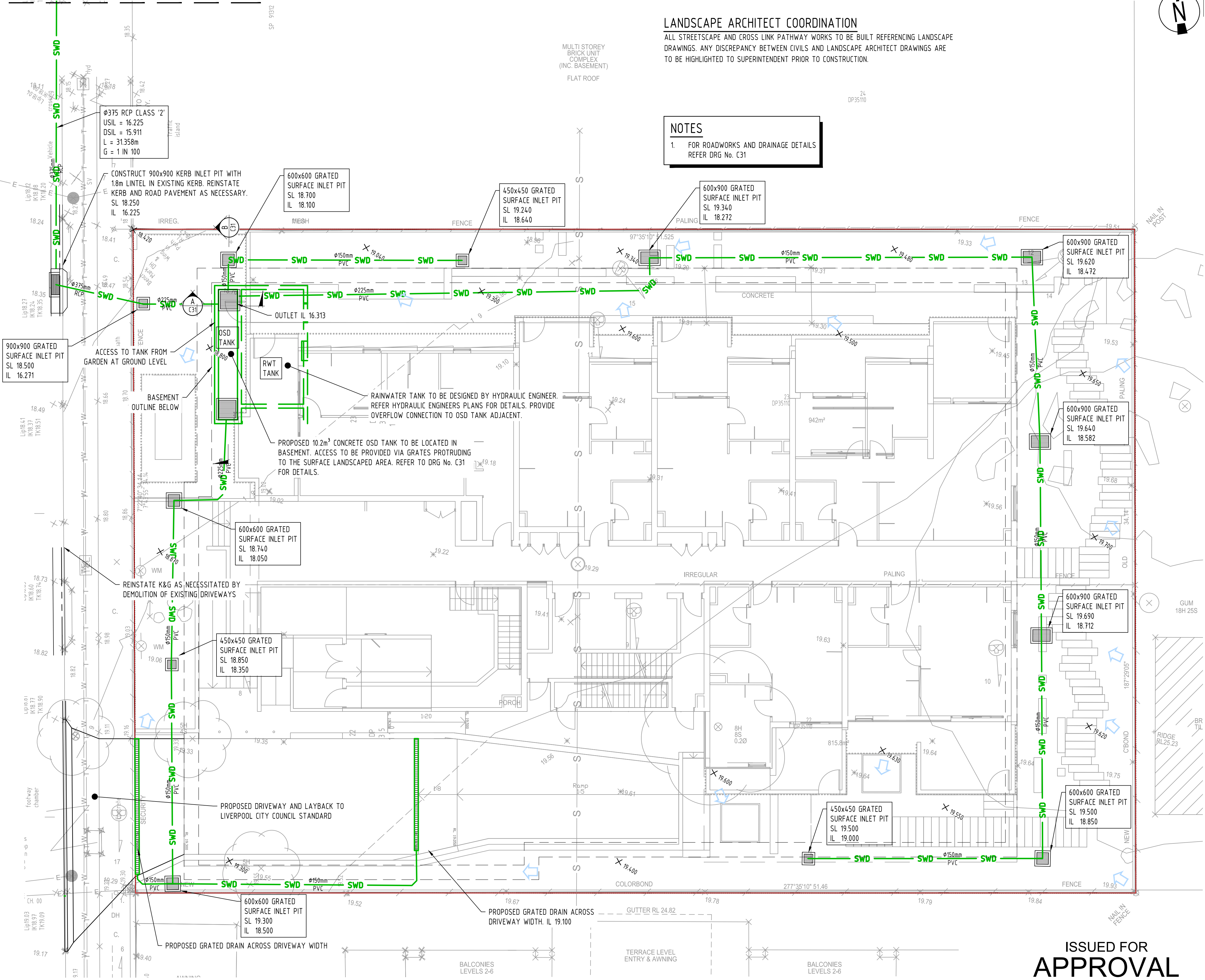

LANDSCAPE ARCHITECT COORDINATION

ALL STREETSCAPE AND CROSS LINK PATHWAY WORKS TO BE BUILT REFERENCING LANDSCAPE DRAWINGS. ANY DISCREPANCY BETWEEN CIVILS AND LANDSCAPE ARCHITECT DRAWINGS ARE TO BE HIGHLIGHTED TO SUPERINTENDENT PRIOR TO CONSTRUCTION.

NOTES

- FOR ROADWORKS AND DRAINAGE DETAILS REFER DRG No. C31

ISSUED FOR
APPROVAL

Rev	Date	Description	By	Chk
E	27.03.20	ISSUED FOR APPROVAL	AGC	ST
D	16.05.19	ISSUED FOR DA	SF	JRH
C	06.05.19	ISSUED FOR DA - AMENDED PIT LOCATION	SF	JRH
B	02.05.19	ISSUED FOR DA	SF	JRH
A	29.04.19	Issued for information	SF	JRH

0 1 2 3 4 5m
SCALE 1:100
AT ORIGINAL SIZE (A1)



Sydney Office
Suite 1301, Level 13, 20 Berry Street
North Sydney, New South Wales 2060, Australia

T 1300 657 402 F +617 3871 2266
E info@adg.com W www.adg.com
BRISBANE / DARWIN / GOLD COAST / MELBOURNE / PERTH /
SUNSHINE COAST / SYDNEY / TOOWOOMBA

Client
HUTCHINSON BUILDERS

Project Name
4-6 BIGGE STREET
WARWICK FARM

Discipline
CIVIL

Designed By
SF

Project No.
21677

Status
PRELIMINARY

Checked By
JRH

Drawn By
SF

Approved By
JRH

Scale at A1
AS SHOWN

Title
ROADWORKS AND DRAINAGE
LAYOUT PLAN

Drawing No.
C30

Revision
E

- REFER TO DWG C01 FOR GENERAL NOTES.
2. REFER HYDRAULIC DRAWINGS FOR BASEMENT, ROOF AND UPPER LEVEL TERRACES DRAINAGE.
3. ALL ROADWORKS AND DRAINAGE (EXTERNAL TO SITE BOUNDARIES AND/OR COUNCIL OWNED DRAINAGE PIPES INTERNAL TO THE SITE BOUNDARIES) CONSTRUCTION AND TESTING TO BE IN ACCORDANCE WITH LIVERPOOL CITY COUNCIL DEVELOPMENT GUIDELINES, DRAWINGS AND SPECIFICATIONS.
4. ALL DRAINAGE CONSTRUCTION (PRIVATELY OWNED DRAINAGE LINES INTERNAL TO THE SITE BOUNDARIES) CONSTRUCTED AND TESTED TO BE IN ACCORDANCE WITH RELEVANT AUSTRALIAN STANDARDS.
5. ALL STORMWATER DRAINAGE PIPES INTERNAL TO SITE SHALL BE:
 - a) 225 DIA TO 375 DIA uPVC S8 RUBBER RING JOINTED, BLACKMAX OR APPROVED EQUIVALENT.
 - b) 450 DIA TO 600 DIA PP S8 RUBBER RING JOINTED, BLACKMAX OR APPROVED EQUIVALENT.
6. ALL STORMWATER DRAINAGE PIPES EXTERNAL TO SITE SHALL BE:
 - a) 300 DIA AND GREATER CLASS 2 OR 3 R.C. RUBBER RING JOINTED
7. ALL STORMWATER PIPES ARE TO BE MANUFACTURED TO RELEVANT AUSTRALIAN STANDARDS INCLUDING BUT NOT LIMITED TO AS4058 AND AS1992.
8. STORMWATER DRAINAGE AND STRUCTURES HAVE BEEN DESIGNED FOR OPERATIONAL LOADS ONLY. CONTRACTOR TO CONSIDER CONSTRUCTION LOADINGS AND ENSURE NO EXCESSIVE LOADS ARE PLACED ON STORMWATER DRAINAGE OR STRUCTURES.
9. ALL PRECAST END STRUCTURES TO BE CONSTRUCTED WITH REINFORCED CONCRETE END WALL.
10. CONTRACTOR TO CONFIRM LOCATION AND LEVEL OF EXISTING STORMWATER DRAINAGE WHERE CONNECTING ON TO EXISTING.
11. CONTRACTOR TO NOTIFY THE SUPERINTENDENT OF ANY UNSUITABLE FOUNDING MATERIAL WITHIN DRAINAGE TRENCH OR STORMWATER STRUCTURES AND AWAIT DIRECTION PRIOR TO LAYING OF PIPES.
12. TRENCH BACKFILL UNDER PAVEMENT TO BE COMPACTED TO 100% STANDARD DRY DENSITY (AS1289 5.1.1) IN LAYERS NOT EXCEEDING 150mm OF CBR 15 MATERIAL OR APPROVED EQUIVALENT. TRENCH BACKFILL IN ROADS TO BE MINIMUM CBR15 MATERIAL UP TO ROAD SUBGRADE LEVEL.
13. ALL STORMWATER GRATES/LIDS WITHIN TRAFFICABLE AREAS TO BE CLASS "D" IN ACCORDANCE WITH AS3996.
14. ALL GRATES AND LIDS SHALL SIT FLAT WITH ITS SURROUND AND NOT BE LOOSE OR MOVE UNDER WHEEL LOADS.
15. ALL STORMWATER STRUCTURES TO BE CONSTRUCTED IN ACCORDANCE WITH PROJECT SPECIFICATION, AND LOCAL AUTHORITY GUIDELINES AND SPECIFICATIONS. WHERE STRUCTURES EXCEED MAXIMUM DEPTH AS IDENTIFIED WITHIN STANDARD DRAWINGS THE CONTRACTOR WILL ENSURE AN ADEQUATE STRUCTURAL DESIGN IS UNDERTAKEN FOR THE SUBJECT STRUCTURE TO BE CONSTRUCTED TO.
16. CONTRACTOR TO ENSURE ALL MANHOLE STRUCTURES COMPLY WITH THE MAXIMUM DEPTH SPECIFIED IN THE PROJECT SPECIFICATION OR LOCAL AUTHORITY FROM FINISHED SURFACE LEVEL TO UNDERSIDE OF ROOF SLAB. ANY NON CONFORMANCE IS TO BE RECTIFIED AT THE CONTRACTORS EXPENSE.
17. CONTRACTOR TO INSTALL STEP IRONS WITHIN MANHOLES/FIELD INLETS WHERE REQUIRED BY LOCAL AUTHORITY.
18. ALL FOOTPATHS TO BE CONSTRUCTED IN ACCORDANCE WITH ARCHITECTURAL/LANDSCAPING DRAWINGS AND RELEVANT AUTHORITY STANDARD DRAWINGS AND SPECIFICATIONS. FOOTPATHS TO BE CONSTRUCTED WITH MAXIMUM 2% CROSSFALL. SHOULD CONSTRUCTED FOOTPATHS EXCEED 2.5% CROSSFALL, THE CONTRACTOR WILL BE REQUIRED TO RECTIFY BY REMOVING AND REPLACING AT THEIR COST.
19. WHERE A STORMWATER DRAINAGE TRENCH HAS BEEN CONSTRUCTED LONGITUUDINALLY IN THE ROAD, THEN THE FINAL PAVEMENT SURFACE REPAIR WIDTH IS TO MATCH THE EXISTING LANE WIDTH AND TERMINATE 50mm CLEAR OF THE ROAD CENTERLINE OR LANE LINE LINEMARKING TO ALLOW FOR THE BITUMEN EMULSION JOINT SEAL. REINSTATEMENT OF SURFACE ADJACENT TO THE KERB OR ROAD PAVEMENT EDGE TO EXTEND FULLY TO THE KERB LINE OR EDGE OF PAVEMENT.
20. THE CONTRACTOR IS TO CONFIRM THE LOCATION OF SERVICE CONDUITS WITH THE SUPERINTENDENT PRIOR TO LAYING STORMWATER DRAINAGE. ALL TRENCH EXCAVATION AND CONSTRUCTION SHALL COMPLY WITH THE REQUIREMENTS OF THE QUEENSLAND WORKPLACE HEALTH AND SAFETY ACT 2011.
21. REMOVE ANY REDUNDANT DRAINAGE OUTLETS FROM THE KERB AND CHANNEL INCLUDING ANY ASSOCIATED PIPEWORK ACROSS THE FOOTWAY AND REINSTATE THE KERB AND CHANNEL AND THE FOOTWAY AREA IN ACCORDANCE WITH COUNCIL GUIDELINES.
22. CONTRACTOR TO UNDERTAKE ROADWORKS TESTING IN ACCORDANCE WITH COUNCIL GUIDELINES, DRAWINGS AND SPECIFICATIONS.
23. CONTRACTOR TO UNDERTAKE AND PROVIDE CCTV OF ALL STORMWATER LINES AT ON MAINTENANCE AND OFF MAINTENANCE. SHOULD THE CCTV IDENTIFY DAMAGE OR CRACKING WITHIN THE STORMWATER PIPES, THE CONTRACTOR WILL RECTIFY THE DAMAGE WITHIN THE PIPES BY MEANS DIRECTED BY THE SUPERINTENDENT WHICH MAY INCLUDE BUT NOT BE LIMITED TO PIPE RELINING OR PIPE REPLACEMENT.

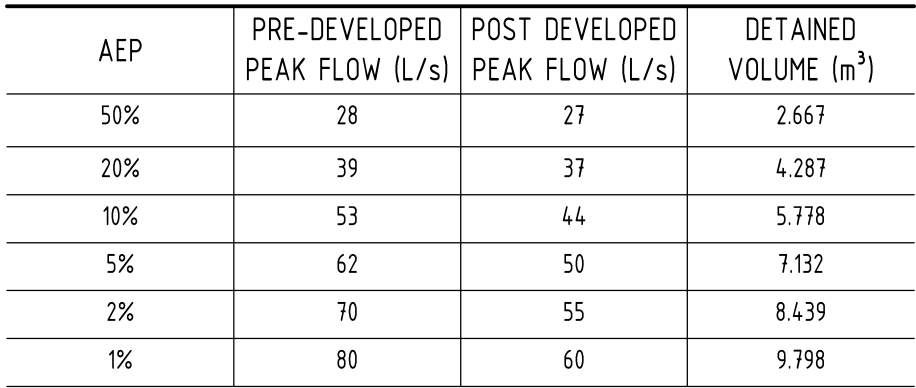

Technical drawing of a square plate with the following specifications:

- Overall dimensions: 0.50m x 0.50m
- Central circular opening: 250mm x 250mm (behind)
- Material: 500x500x6mm NON CORROSIVE S.S. PLATE
- Four 4x10mm DYNABOLTS (bolts) are shown at the corners.
- Four Ø140mm ORIFICE WITH SHARP EDGES are shown, MACHINED TO $\pm 0.5\text{mm}$ ACCURACY.
- Dimension 0.05m TYP. is indicated for the distance from the edge to the central opening.
- Dimension 0.13m is indicated for the distance from the edge to the orifice.

SCREEN TO BE ORIENTED SO THAT OPENINGS ARE ANGLED FACING TOWARDS THE OUTLET

LYSAGHT MAXIMESH RH3030 (HOT DIPPED GALVANISED) OR EQUIVALENT

LIFTING HANDLE/S

2x TRIANGULAR MAXIMESH PANELS TO BE WELDED TO RECTANGULAR PANNEL TO FORM SCREEN

MAX. 0.60m

MAX. 0.60m

MAX. 0.60m

NTS

ROADWORKS AND DRAINAGE

NOTES AND DETAILS

C	27.03.20	ISSUED FOR APPROVAL		AGC	ST
B	16.05.19	ISSUED FOR DA		SF	JRH
A	02.05.19	ISSUED FOR DA		SF	JRH
Rev	Date	Description		By	Chk

--	--



Sydney Office
Suite 1301, Level 13, 20 Berry Street
North Sydney, New South Wales 2060, Australia

T 1300 657 402 F +617 3871 2266
E info@adgco.com W www.adgco.com

BRISBANE / DARWIN / GOLD COAST / MELBOURNE / PERTH /
SUNSHINE COAST / SYDNEY / TOOWOOMBA

Client	HUTCHINSON BUILDERS
Project Name	4-6 BIGGE STREET WARWICK FARM
N	

Discipline CIVIL		Status PRELIMINARY
Designed By SF	Checked By JRH	Approved By JRH
Project No. 21677	Drawn By SF	Scale at A1 AS SHOWN
<p>The concepts and information contained in this document are the copyright of ADG Engineers (Australia) Pty Ltd. Use or copying of the document in whole or in part without the written permission of ADG Engineers (Australia) Pty Ltd constitutes an infringement of copyright.</p> <p>Do not scale drawings. If in doubt, ask!</p>		

Title	
ROADWORKS AND DRAINAGE NOTES AND DETAILS	
Drawing No.	Revision
C31	C

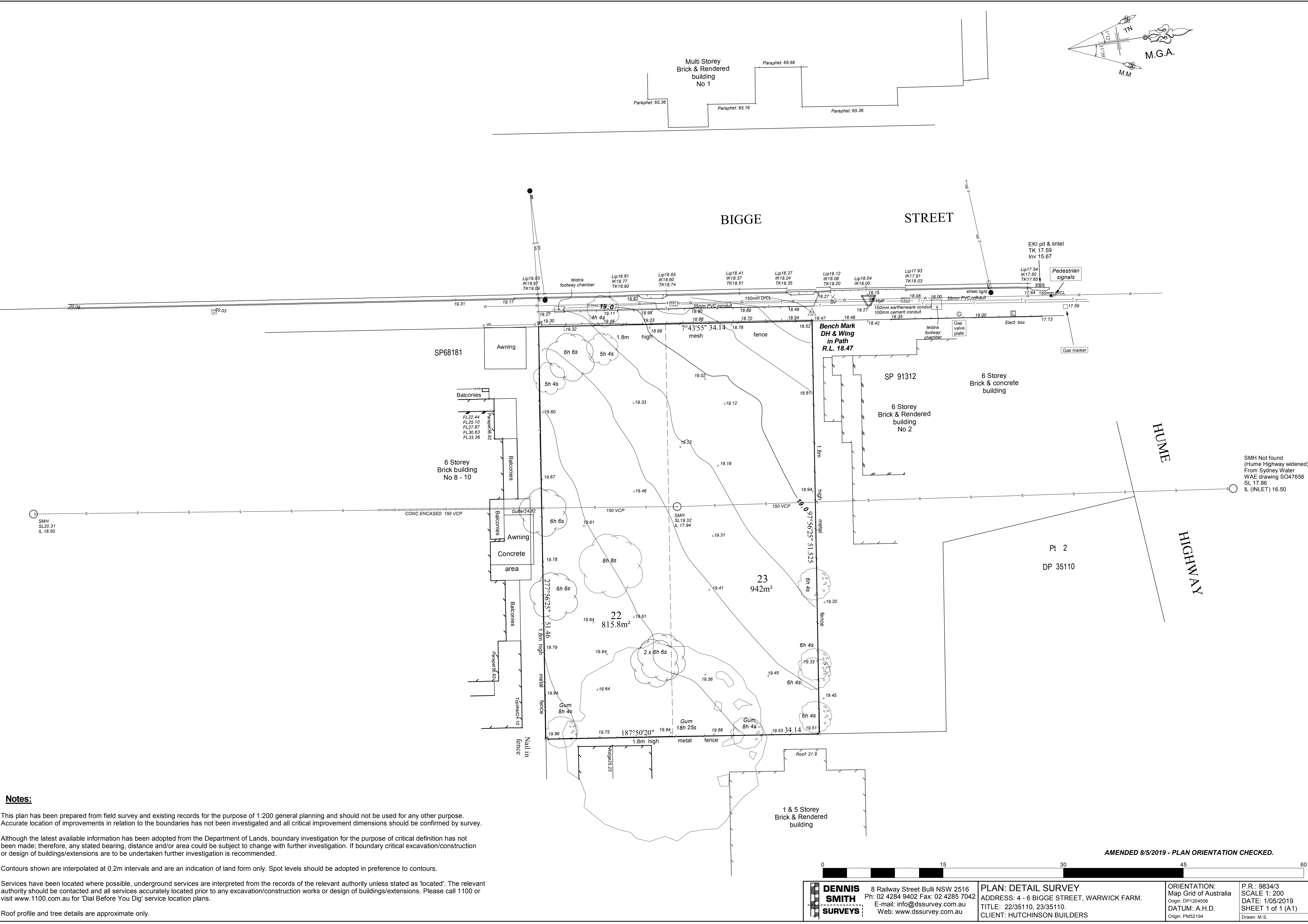

Notes:

This plan has been prepared from field survey and existing records for the purpose of 1:200 general planning and should not be used for any other purpose. Accurate location of improvements in relation to the boundaries has not been investigated and all critical improvement dimensions should be confirmed by survey.

Although the latest available information has been adopted from the Department of Lands, boundary investigation for the purpose of critical definition has not been made; therefore, any stated bearing, distance and/or area could be subject to change with further investigation. If boundary critical excavation/construction or design of buildings/extensions are to be undertaken further investigation is recommended.

Contours shown are interpolated at 0.2m intervals and are an indication of land form only. Spot levels should be adopted in preference to contours.

Services have been located where possible, underground services are interpreted from the records of the relevant authority unless stated as 'located'. The relevant authority should be contacted and all services accurately located prior to any excavation/construction works or design of buildings/extensions. Please call 1100 or visit www.1100.com.au for 'Dial Before You Dig' service location plans.

Roof profile and tree details are approximate only.

	DENNIS SMITH SURVEYS	8 Railway Street Bulli NSW 2516 Ph: 02 4284 9402 Fax: 02 4285 7042 E-mail: info@dssurvey.com.au Web: www.dssurvey.com.au	PLAN: DETAIL SURVEY ADDRESS: 4 - 6 BIGGE STREET, WARWICK FARM. TITLE: 22/35110, 23/35110. CLIENT: HUTCHINSON BUILDERS	ORIENTATION: Map Grid of Australia Origin: DP1204506 DATUM: A.H.D. Origin: PM52194	P.R.: 9834/3 SCALE 1: 200 DATE: 1/05/2019 SHEET 1 of 1 (A1) Drawn: M.S.
	AMENDED 8/5/2019 - PLAN ORIENTATION CHECKED.				